

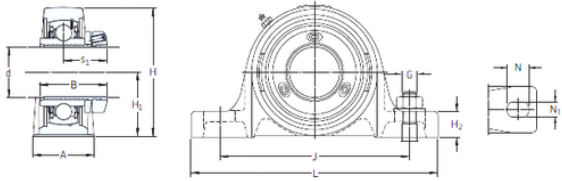

# NTN BEARING-SUDAMERICANA, S.A.



## SKF SY 1.1/2 PF/AH Bearing unit

Bearing No. SY 1.1/2 PF/AH

SY 1.1/2 PF/AH Bearing 2D drawings and 3D CAD models

Bore Diameter	38,1 mm
Width	50,8 mm
d	38,1 mm
s1	33,8 mm
A	48 mm
B	50,8 mm
G	12 mm
H	99 mm
H1	49,2 mm
H2	19 mm
J	135,5 mm
L	175 mm
N	25,5 mm
N1	14 mm
Weight	1,95 Kg
Basic dynamic load rating (C)	30,7 kN
Basic static load rating (C0)	19 kN
Category	Pillow Block Bearings
Inventory	0.0
Manufacturer Name	SKF
Minimum Buy Quantity	N/A
Weight / Kilogram	2.216
EAN	7316572045497
Product Group	M06110
Number of Mounting Holes	2
Mounting Method	Stepped Sleeve



## NTN BEARING-SUDAMERICANA, S.A.

Housing Style	2 Bolt Pillow Block
Rolling Element	Ball Bearing
Housing Material	Cast Iron
Expansion / Non-expansion	Non-expansion
Mounting Bolts	1/2 Inch
Relubricatable	Yes
Insert Part Number	YSP 208-108-2F/AH
Seals	M Seal
Housing Configuration	1 Piece Solid
Inch - Metric	Inch
Other Features	Single Row   Standard Duty   Wide Inner Race   Air Handling   Anti Rotation Pin   Has Flinger   Y Bearing   With Grub Screw
Long Description	2 Bolt Pillow Block; 1-1/2" Bore; 1-15/16" Base to Center Height; Stepped Sleeve Mount; Ball Bearing; 4-15/16" Minimum Bolt Spacing; 5-3/4" Bolt Spacing Maximum; Relubricatable; Ca
Category	Pillow Block
UNSPSC	31171511
Harmonized Tariff Code	8483.20.40.40
Noun	Bearing
Keyword String	Pillow Block
Manufacturer URL	<a href="http://www.skf.com">http://www.skf.com</a>
Manufacturer Item Number	SY 1.1/2 PF/AH
Weight / LBS	4.3
Nominal Bolt Center to Center	5.4 Inch   136 Millimeter
Bolt Spacing Maximum	5.75 Inch   146.05 Millimeter
Base to Center Height	1.938 Inch   49.225 Millimeter



## NTN BEARING-SUDAMERICANA, S.A.

Length Thru Bore	2.063 Inch   52.4 Millimeter
Bore	1.5 Inch   38.1 Millimeter
Bolt Spacing Minimum	4.938 Inch   125.425 Millimeter
Actual Bolt Center to Center	0 Inch   0 Millimeter