

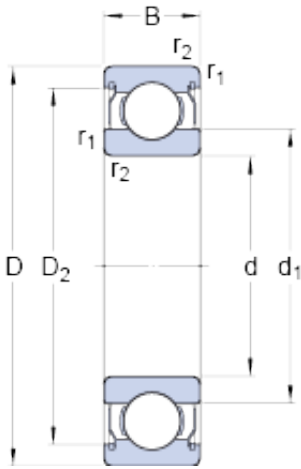

NTN BEARING-SUDAMERICANA, S.A.



8 mm x 12 mm x 3.5 mm SKF W 637/8-2ZS Ball bearing

Bearing No. W 637/8-2ZS

W 637/8-2ZS Bearing 2D drawings and 3D CAD models

Size	12x8x3.5 mm
Bore Diameter	12 mm
Outer Diameter	8 mm
Width	3,5 mm
d	8 mm
D	12 mm
B	3.5 mm
d ₁	9.05 mm
D ₂	11.33 mm
r _{1,2} - min.	0.1 mm
d _a - min.	8.8 mm
d _a - max.	9 mm
D _a - max.	11.5 mm
r _a - max.	0.1 mm
Basic dynamic load rating - C	0.364 kN
Basic static load rating - C ₀	0.143 kN
Fatigue load limit - P _u	0.006 kN
Reference speed	100000 r/min
Limiting speed	50000 r/min
Calculation factor - k _r	0.02
Calculation factor - f ₀	8.2
d ₁	9.05 mm
D ₂	11.33 mm
r _{1,2} min.	0.1 mm



NTN BEARING-SUDAMERICANA, S.A.

d_a min.	8.8 mm
d_a max.	9 mm
D_a max.	11.5 mm
r_a max.	0.1 mm
Basic dynamic load rating C	0.312 kN
Basic static load rating C_0	0.14 kN
Fatigue load limit P_u	0.006 kN
Calculation factor k_r	0.02
Calculation factor f_0	8.2
Mass bearing	0.001 kg